



DIESEL GENERATOR SET LG66C SPECIFICATION

Model	Power Rating	Voltage Available				
		PRIME(1)	STANDBY(2)			
LG66C	220V/60Hz	48KW	53KW	208/120v	220/127v	240/139v
	PF:0.8	60KVA	66KVA	380/220v	440/254v	480/277v 600/347v

GENERAL INFORMATION

DIESEL GENERATOR SET

Model	LG66C
Motor	Cummins 4BTA3.9G2
Alternator	Stamford UCI224D
Speed Control Type	Electronical
Phase	Three
Fuel Tank Capacity	
System Voltage	24V
Frequency	60HZ
Engine Coolant Flow	0.132m³/m
Air Intake Flow	4.98m³/m
Exhaust Air Flow	13.56m³/m
Exhaust Temperature	560°C

ENGINE

Maximum Output(kw)	74KW
Number of Cylinders	4
Aspiration	Turbocharged
Cycle	4
Fuel Type	Diesel
Combustion Type	Direct Injection
Cooling Type	Water Cooled
Bore	102mm
Stroke	120mm
Displacement	3.9 L
Compression Ratio	17.3:1
Lubrication Capacity	9.5 liter
Coolant Capacity	8.3 liter

Fuel consumption	1800rpm
	L/hr
Standby Power(2)	19
Prime Power(1)	17
75% Prime Power(1)	13
50% Prime Power(1)	9

Alternator

Insulation	Class "H"
Excitation Type	Self-excitation (PMG for optional)
Protection Class	IP23

Dimension	Open	Silent
Length (A)	1750mm	2670mm
Width (B)	970mm	1080mm
Height (C)	1500mm	1865mm
Net Weight	1170KG	1490KG

Certificates

Engine	ISO 3046, BS 5514, DIN 6271
Alternator	UTE NFC 51-111-105-110
	ICE34-1, BS 5000-4999
	NEMA MG 21, VDE 0530
Generator Set	ISO 8528 CSA

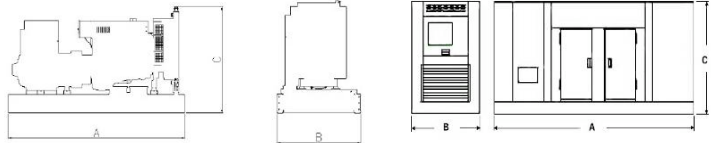

(1) Prime Power: ratings are as per DIN 6271, BS55114 and ISO-3046 with 10% overload capacity

(2) Standby Power: Power available at variable load for up to a max. of 500 hours during one year of which 300 hours may be for continuous use

(3) Operation at Altitude ≤ 1500m, Ambient temperature ≤ 40°C. If altitude higher than 1500m, each 100m will cause additional de-rating 1%.

Certification ISO 9001:2000

Fujian Everstrong Lega Power Equipments Co., Ltd
 Address: Fuqing Hong Kuan Industry Zone, Fuzhou, Fujian Province, China
 Tel: +86-591-83859146
 Fax: +86-591-83853130
 Email: sales@legapower.com
 Web: www.legapower.com

We are always available™



We are always
Available