



DIESEL GENERATOR SET LG388C SPECIFICATION

Model	Power Rating	Voltage Available					
		PRIME(1)	STANDBY(2)				
LG388C	220V/60Hz	280KW	310KW	208/120v	220/127v	240/139v	
	PF:0.8	350KVA	388KVA	380/220v	440/254v	480/277v	600/347v

GENERAL INFORMATION

DIESEL GENERATOR SET

Model	LG388C
Motor	Cummins NTA855G1B
Alternator	Stamford HCI444D
Speed Control Type	Electronical
Phase	Three
Fuel Tank Capacity	
System Voltage	24V
Frequency	60HZ
Engine Coolant Flow	6L/min
Air Intake Flow	27.78m³/m
Exhaust Air Flow	72.78m³/m
Exhaust Temperature	482°C

ENGINE

Maximum Output(kw)	347KW
Number of Cylinders	6
Aspiration	Turbocharged & Charge Air Cooled
Cycle	4
Fuel Type	Diesel
Combustion Type	Direct Injection
Cooling Type	Water Cooled
Bore	140mm
Stroke	150mm
Displacement	14 L
Compression Ratio	14.0:1
Lubrication Capacity	36liter
Coolant Capacity	20.8liter

Fuel consumption	1800rpm
	L/hr
Standby Power(2)	89.2
Prime Power(1)	80.5
75% Prime Power(1)	61.7
50% Prime Power(1)	44.0

Alternator

Insulation	Class "H"
Excitation Type	Self-excitation (PMG for optional)
Protection Class	IP23

Dimension	Open	Silent
Length (A)	3050mm	4350mm
Width (B)	1150mm	1400mm
Height (C)	1750mm	2260mm
Net Weight	3530KG	4020KG

Certificates

Engine	ISO 3046, BS 5514, DIN 6271
Alternator	UTE NFC 51-111-105-110
	ICE34-1, BS 5000-4999
	NEMA MG 21, VDE 0530
Generator Set	ISO 8528 CSA

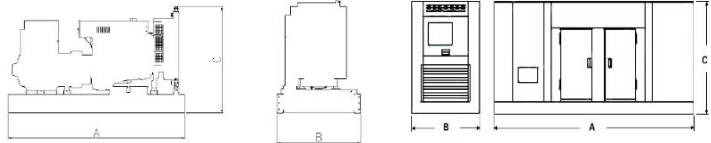

(1) Prime Power: ratings are as per DIN 6271, BS55114 and ISO-3046 with 10% overload capacity

(2) Standby Power: Power available at variable load for up to a max. of 500 hours during one year of which 300 hours may be for continuous use

(3) Operation at Altitude ≤ 1500m, Ambient temperature ≤ 40°C. If altitude higher than 1500m, each 100m will cause additional de-rating 1%.

Certification ISO 9001:2000

Fujian Everstrong Lega Power Equipments Co., Ltd
 Address: Fuqing Hong Kuan Industry Zone, Fuzhou, Fujian Province, China
 Tel: +86-591-83859146
 Fax: +86-591-83853130
 Email: sales@legapower.com
 Web: www.legapower.com

We are always available™

