



DIESEL GENERATOR SET LG35C SPECIFICATION

Model		Power Rating		Voltage Available			
		PRIME(1)	STANDBY(2)				
LG35C	220V/60Hz	25KW	28KW	208/120v	220/127v	240/139v	
	PF:0.8	31KVA	35KVA	380/220v	440/254v	480/277v	600/347v

GENERAL INFORMATION

DIESEL GENERATOR SET

Model	LG35C
Motor	Cummins 4B3.9G2
Alternator	Stamford PI144E
Speed Control Type	Electronical
Phase	Three
Fuel Tank Capacity	
System Voltage	24V
Frequency	60HZ
Engine Coolant Flow	0.132m³/m
Air Intake Flow	2.04m³/m
Exhaust Air Flow	4.32m³/m
Exhaust Temperature	410°C

ENGINE

Maximum Output(kw)	30KW
Number of Cylinders	4
Aspiration	Natural inspire
Cycle	4
Fuel Type	Diesel
Combustion Type	Direct Injection
Cooling Type	Water Cooled
Bore	102mm
Stroke	120mm
Displacement	3.9 L
Compression Ratio	16.5:1
Lubrication Capacity	9.5 liter
Coolant Capacity	7.2liter

Fuel consumption	1800rpm
	L/hr
Standby Power(2)	7.8
Prime Power(1)	7.0
75% Prime Power(1)	5.5
50% Prime Power(1)	4.5

Alternator

Insulation	Class "H"
Excitation Type	Self-excitation (PMG for optional)
Protection Class	IP23

Dimension	Open	Silent
Length (A)	1750mm	2450mm
Width (B)	970mm	1080mm
Height (C)	1500mm	1865mm
Net Weight	850KG	1160KG

Certificates

Engine	ISO 3046, BS 5514, DIN 6271
Alternator	UTE NFC 51-111-105-110 ICE34-1, BS 5000-4999 NEMA MG 21, VDE 0530
Generator Set	ISO 8528 CSA

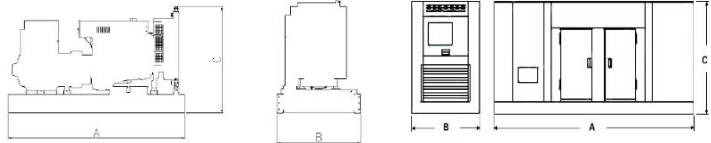

(1) Prime Power: ratings are as per DIN 6271, BS55114 and ISO-3046 with 10% overload capacity

(2) Standby Power: Power available at variable load for up to a max. of 500 hours during one year of which 300 hours may be for continuous use

(3) Operation at Altitude ≤ 1500m, Ambient temperature ≤ 40°C. If altitude higher than 1500m, each 100m will cause additional de-rating 1%.

Certification ISO 9001:2000

Fujian Everstrong Lega Power Equipments Co., Ltd
Address: Fuqing Hong Kuan Industry Zone, Fuzhou, Fujian Province, China
Tel: +86-591-83859146
Fax: +86-591-83853130
Email: sales@legapower.com
Web: www.legapower.com

We are always available™



We are always
Available