



DIESEL GENERATOR SET LG110C1 SPECIFICATION

Model	Power Rating		Voltage Available			
	PRIME(1)	STANDBY(2)				
LG110C1 220V/60Hz PF:0.8	80KW 100KVA	88KW 110KVA	208/120v 380/220v	220/127v 440/254v	240/139v 480/277v	600/347v

GENERAL INFORMATION

DIESEL GENERATOR SET

Model	LG110C1
Motor	Cummins 6BT5.9G1
Alternator	Stamford UCI224G
Speed Control Type	Mechanical
Phase	Three
Fuel Tank Capacity	
System Voltage	24V
Frequency	60HZ
Engine Coolant Flow	0.144m³/m
Air Intake Flow	8.22m³/m
Exhaust Air Flow	18.3m³/m
Exhaust Temperature	540°C

ENGINE

Maximum Output(kw)	127KW
Number of Cylinders	4
Aspiration	Turbocharged
Cycle	4
Fuel Type	Diesel
Combustion Type	Direct Injection
Cooling Type	Water Cooled
Bore	102mm
Stroke	120mm
Displacement	5.9 L
Compression Ratio	17.3:1
Lubrication Capacity	14.2 liter
Coolant Capacity	7.9 liter

Fuel consumption	1800rpm
	L/hr
Standby Power(2)	33.6
Prime Power(1)	29.7
75% Prime Power(1)	22.2
50% Prime Power(1)	15.6

Alternator

Insulation	Class "H"
Excitation Type	Self-excitation (PMG for optional)
Protection Class	IP23

Dimension	Open	Silent
Length (A)	2200mm	2900mm
Width (B)	980mm	1080mm
Height (C)	1550mm	2000mm
Net Weight	1250KG	1780KG

Certificates

Engine	ISO 3046, BS 5514, DIN 6271
Alternator	UTE NFC 51-111-105-110 ICE34-1, BS 5000-4999 NEMA MG 21, VDE 0530
Generator Set	ISO 8528 CSA

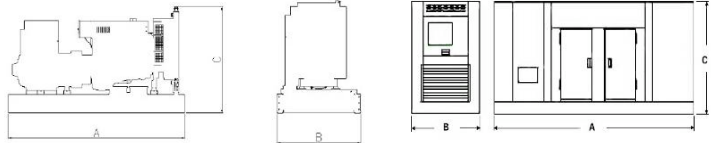

(1) Prime Power: ratings are as per DIN 6271, BS55114 and ISO-3046 with 10% overload capacity

(2) Standby Power: Power available at variable load for up to a max. of 500 hours during one year of which 300 hours may be for continuous use

(3) Operation at Altitude ≤ 1500m, Ambient temperature ≤ 40°C. If altitude higher than 1500m, each 100m will cause additional de-rating 1%.

Certification ISO 9001:2000

Fujian Everstrong Lega Power Equipments Co., Ltd
Address: Fuqing Hong Kuan Industry Zone, Fuzhou, Fujian Province, China
Tel: +86-591-83859146
Fax: +86-591-83853130
Email: sales@legapower.com
Web: www.legapower.com

We are always available™



We are always
Available